

Project	Quantity	Item #
Model Specified:		CSI Section 11400

**ULT Series
Freezer Compact Undercounter
Self-Contained**

27", 48" & 60" Wide Models



ULT27-L
ULT27-R
ULT48-LR
ULT60-LR

Stainless Exterior

Door Style

One Hinged Solid Door
One Hinged Solid Door
Two Hinged Solid Doors
Two Hinged Solid Doors

Hinging

Left
Right
Left/Right
Left/Right



Model ULT60-LR

Traulsen's durable, high performance, compact undercounter freezer models provide a high quality/high value alternative to the all too common commodity types in today's market.

Durable, built with stainless steel exteriors and anodized aluminum interiors, their heavy duty cabinet construction promises years of useful service. Truly front breathing, their design allows for "zero-clearance" installation. As a result they can be placed right up against the back wall and alongside other kitchen equipment, saving valuable floor space.

Additionally, they offer a wide range of optional accessories to choose from, and are ideal for use with many different type applications.

Standard Product Features

- Stainless Steel Exterior Top, Sides & Doors
- Anodized Aluminum Interior
- Front Breathing Self-Contained Refrigeration System
- Environmentally Friendly R-404A Refrigerant
- Self-Closing Stainless Steel Doors With Stay Open Feature At 105° Degrees
- Anodized Aluminum Interior Door Liner
- Interior Mounted Thermometer
- Two (2) Powder Coated Shelves Per Door, Mounted On Pilasters
- Automatic Non-Electric Condensate Evaporator
- Magnetic Snap-In EZ-Clean Door Gasket(s)
- 8' (2.4 m) NEMA Cord & Plug Attached
- Set of Four (4) 6" (15.2 cm) High Adjustable Legs, Six (6) For 60" models
- Three Year Parts And Labor Warranty
- Five Year Compressor Warranty

Accessory Kits*

- **CK20** (four 6" (15.2 cm) high casters for 27" & 48" models)
- **CK21** (six 6" (15.2 cm) high casters for 60" model)
- **CK22** (four 4" (10.2 cm) high casters for 27" & 48" models)
- **CK23** (six 4" (10.2 cm) high casters for 60" model)
- **CK24** (four 3-1/2" (8.9 cm) high casters for 27" & 48" models)
- **CK25** (six 3-1/2" (8.9 cm) high casters for 60" models)
- **CK26** (four 2-3/4" (6.9 cm) high casters for 27" & 48" models)
- **CK27** (six 2-3/4" (6.9 cm) high casters for 60" models)
- **CK28** (four 2-1/2" (6.4 cm) high casters for 27" models)
- **SHELF CPW1** (additional shelf for all 27" models)
- **SHELF48 UPPER** (upper shelf for all 48" models)
- **SHELF48 LOWER** (lower shelf for all 48" models)
- **SHELF60 UPPER** (upper shelf for all 60" models)
- **SHELF60 LOWER** (lower shelf for all 60" models)
- **CU27TOP BSWO** (22 ga. stainless steel top with 4" (10.2 cm) backsplash 27")
- **CU48TOP BSWO** (22 ga. stainless steel top with 4" (10.2 cm) backsplash 48")
- **CU60TOP BSWO** (22 ga. stainless steel top with 4" (10.2 cm) backsplash 60")

*Optional accessory kits shipped separately for field installation.

Factory Installed Options

- Stainless Steel Finished Back
- Other Door Hingings



Intertek



This unit is listed to the applicable UL, CSA and NSF Standards by an approved NRTL. Consult the factory or units data plate for approval information.

Approval: _____



TRAUlsen
4401 BLUE MOUND RD.
PHONE 1 (800) 825-8220
Website: www.traulsen.com

FT. WORTH, TX 76106
FAX-MKTG. 1 (817) 624-4302

Project	Quantity	Item #
Model Specified:		CSI Section 11400

Specifications

Construction, Hardware and Insulation

Cabinet exterior front, one piece sides, and doors are constructed of 22 gauge stainless steel. Cabinet interior and door liners are constructed of anodized aluminum. The exterior cabinet back and bottom are constructed of galvanized steel.

Door self-closes at less than 90 Degrees and also includes a stay open feature at 105 Degrees. Gasket profile and Santoprene® material simplify cleaning and increase overall gasket life. Both the cabinet and door(s) are insulated with an average of 2" (5 cm) thick high density, non-CFC, foamed in place polyurethane.

Refrigeration System

A balanced, rear mounted, front breathing, self-contained refrigeration system using R-404A refrigerant is provided. It features a TXV valve, air-cooled 1930 BTU, 1/2 hp, hermetic compressor, a forced air evaporator coil and a non-electric condensate evaporator. An 8' (2.4 m) NEMA cord and plug is provided. Standard operating temperature for freezer models is 0 to -5°F (-17 to -16°C).

Interior

Standard interior arrangements include two (2) powder coated wire shelves per door, mounted on pilasters. These are adjustable in 1/2" (1.27 cm) increments, allowing for a minimum of 1-1/2" (3.81 m) spacing between shelves.

Warranties

Both a three year parts and labor warranty and a five year compressor warranty (self-contained models only) are provided standard.

Cabinet Dimensional Data								
Model	Storage cu. Ft. ³ (l)	A Width - cabinet in. (cm)	B Width - door in. (cm)	C Depth - door open 90° in. (cm)	Clear door opening in. (cm)	# of doors	# of shelves	Total shelf area ft. ² (m ²)
ULT27	7.1 (201)	27" (69)	25 7/8" (65.7)	55 3/8" (140.7)	22 3/4" (57.8)	1	2	4.88 (.45)
ULT48	13.1 (371)	48" (122)	21 1/8" (53.7)	50 5/8" (128.6)	18" (45.7)	2	4	10.3 (.96)
ULT60	16.7 (473)	60" (152)	25 7/8" (65.7)	55 3/8" (140.7)	22 3/4" (57.8)	2	4	13.2 (1.23)

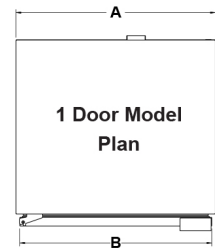

Electrical & Refrigeration Data 115/60/1 NEMA 5-15P					Shipping Data (42"D x 41"H)		
Model	Full Load Amps	Refrigerant	Refrigerant Amount oz. (gr)	BTU/HR (HP)	Width - crated in. (cm)	Volume - crated cu. Ft. ³ (l)	Weight lbs. (kg)
ULT27	8.0	R-404A	11 (312)	1930 (1/2)	45" (114)	55 (1557)	240 (109) net 220 (100) gross
ULT48	8.0	R-404A	16 (454)	1930 (1/2)	69" (175)	77 (2180)	355 (161) net 325 (147) gross
ULT60	8.0	R-404A	16 (454)	1930 (1/2)	69" (175)	91 (2577)	457 (207) net 365 (166) gross

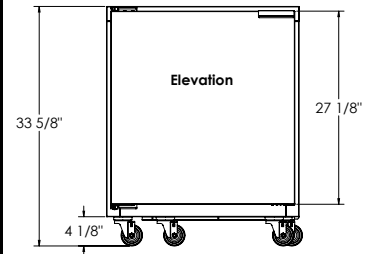

NOTES:

- Compressor BTU based on a 90°F (32° C) degree ambient and 20°F (-6°C) degree evaporator.
- When ordering please specify: voltage, hinging and optional accessories.

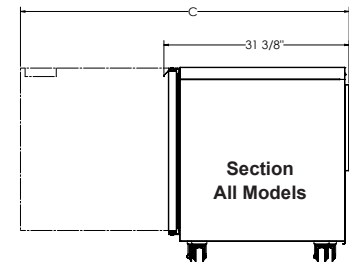
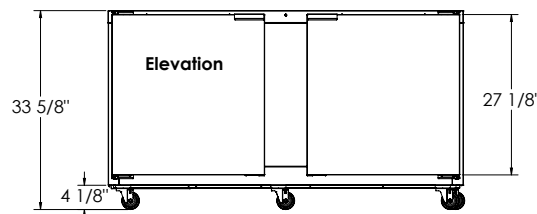
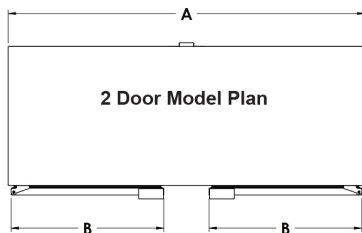

Part No. TR35925 (REV. 05-01-17)

Continued product development may necessitate specification changes without notice.

TRAULSEN
4401 BLUE MOUND RD.
PHONE 1 (800) 825-8220
Website: www.traulsen.com

FT. WORTH, TX 76106
FAX-MKTG. 1 (817) 624-4302

